

ems cold room hinged door KTM 80

Features

Fields of application:

Cold rooms, cold stores, cold halls, cold cells up to 0°C

U value door leaf in W/m²K 0.30

Dimensions:

Clear width (CW): max. 1,500 mm

Clear height (CH): max. 3,800 mm

Other sizes are available as special design, on request.

Details of the ems cold room hinged door KTM 80

Door leaf

Door leaf thickness 80 mm, foamed with PU rigid foam, foaming agent CFC-free and HCFC-free.

Vertical butt joint from CW 1,100 mm

Sealing

Three sides held in plastic profiles, grease-resistant EPDM insert sealing. EPDM abrasive rubber sealing at bottom of door leaf. All sealings can be easily replaced.

Option: silicone sealing black or white.

Door frames installed in brickwork

Standard design: metal frame (100 x 70 mm) foamed with PU hard form, metal-sheeted in the design of the door leaf with and without threshold. Ready to install with assembly material and installation instructions.

Door frame with panel installation

Clamp frame (100 x 45 mm) metal-sheeted in the design of the door leaf with and without threshold. Prepared ready to install for the respective panel thickness, with assembly material and installation instructions.

Options (on request) i.a.:

- Allround frame (e.g. for cells, 'walk-in-rooms', or similar facilities)
- Tubular track lead-through

Covering sheet steel design

Galvanized Quality Class Z275, corrosive protection class III pursuant to DIN 55928.

Polyester coating, 25 µm in industrial colours pursuant to ems colour table.

Options (on request):

Food-compatible coating FS3000®, 25 µm, physiologically harmless, in various colours:

Covering stainless steel design

Nickel-chromium steel (CNS) 1.4301, non-rusting pursuant to DIN 17440, circular-matted, grounded, brushed or pattern-rolled lengthwise (5WL).

Door hardware

Standard design: Rising hinges of CNS 1.4301 in plastic compound, three-dimensional adjustment. ems-press handle with three keys

Options (on request) i.a.

- Window 400 x 600 mm
- Three-point lock
- Overhead door closer
- Fender
- Equalizing valve
- Door catch
- Double-winged design

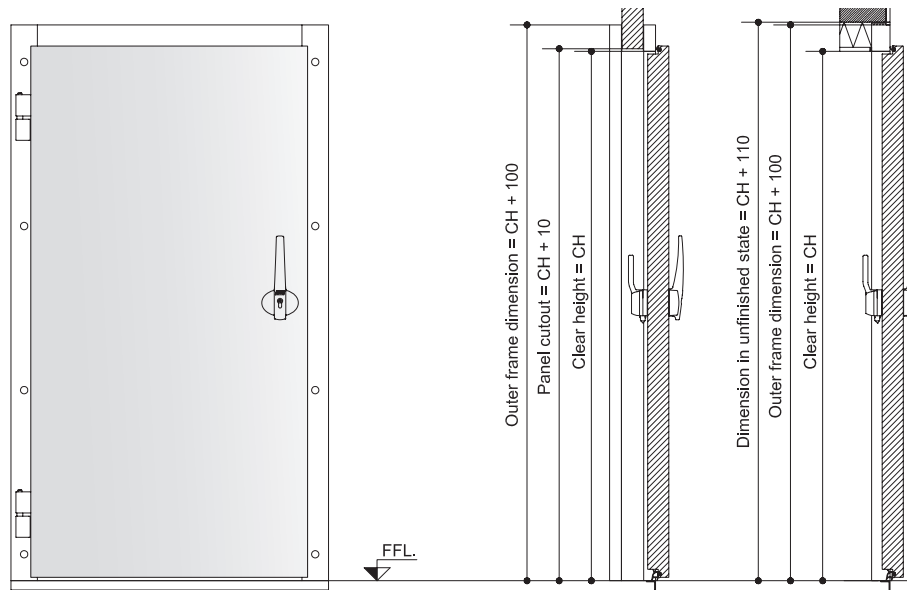

Detailed sections

Panel installation DIN left (DIN right mirror-inverted)

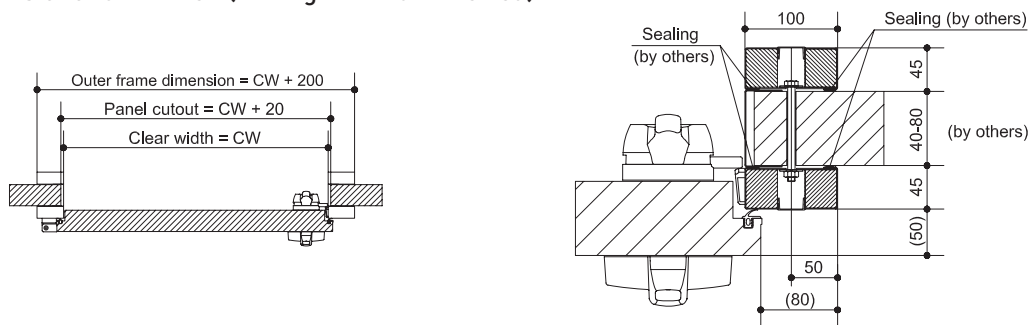

Brickwork installation DIN left (DIN right mirror-inverted)

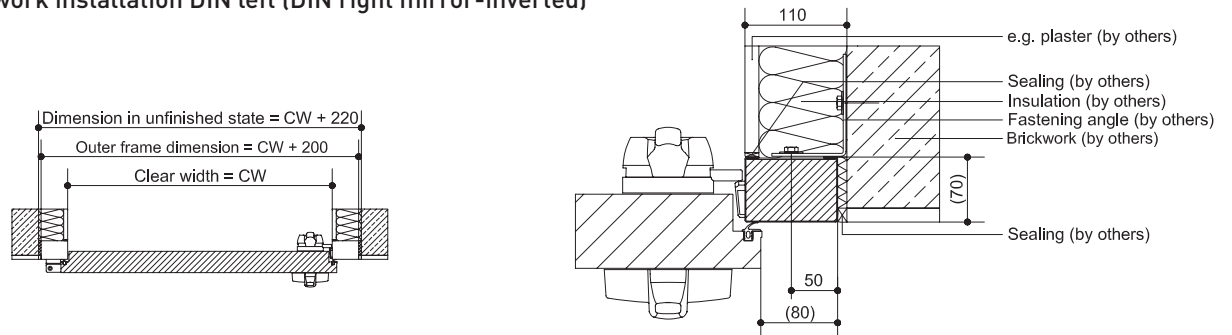

Threshold installation (example)

